

Supporting Documents

1. Bristol Zoo Gardens, Guthrie Road, BS8 3HA.

1. Extent of Listed Building Consent Application
2. Clifton Conservation Hub (Entrance Lodge) - Proposed Elevations
3. Clifton Conservation Hub (Entrance Lodge) - Proposed Floor and Roof Plans
4. Bear Pit - Proposed Elevations & Sections
5. Bear Pit - Proposed Floor Plans
6. Birds of Prey Aviary - Proposed Elevations
7. Giraffe House - Proposed Elevations
8. Giraffe House - Proposed Floor Plans
9. Guthrie Road Entrance Gates – Proposals
10. Monkey Temple - Proposed Drawings

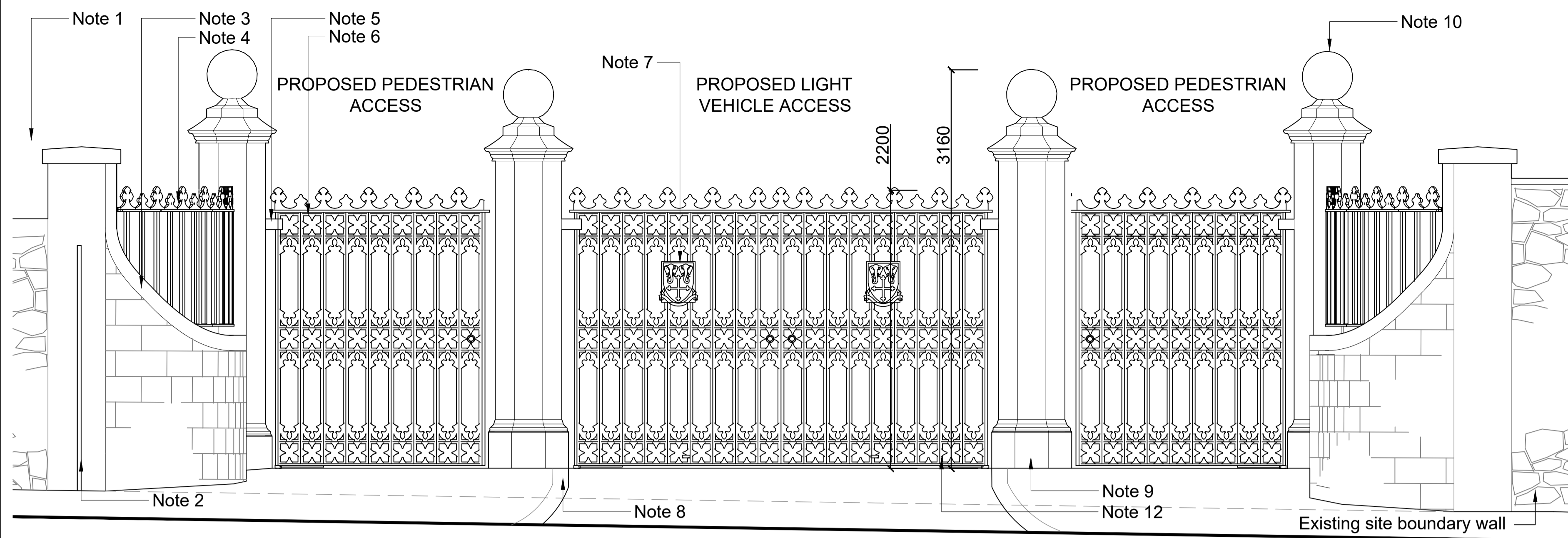

1 Elevation A: Guthrie Road Gates: Proposed
Scale 1:25@A1

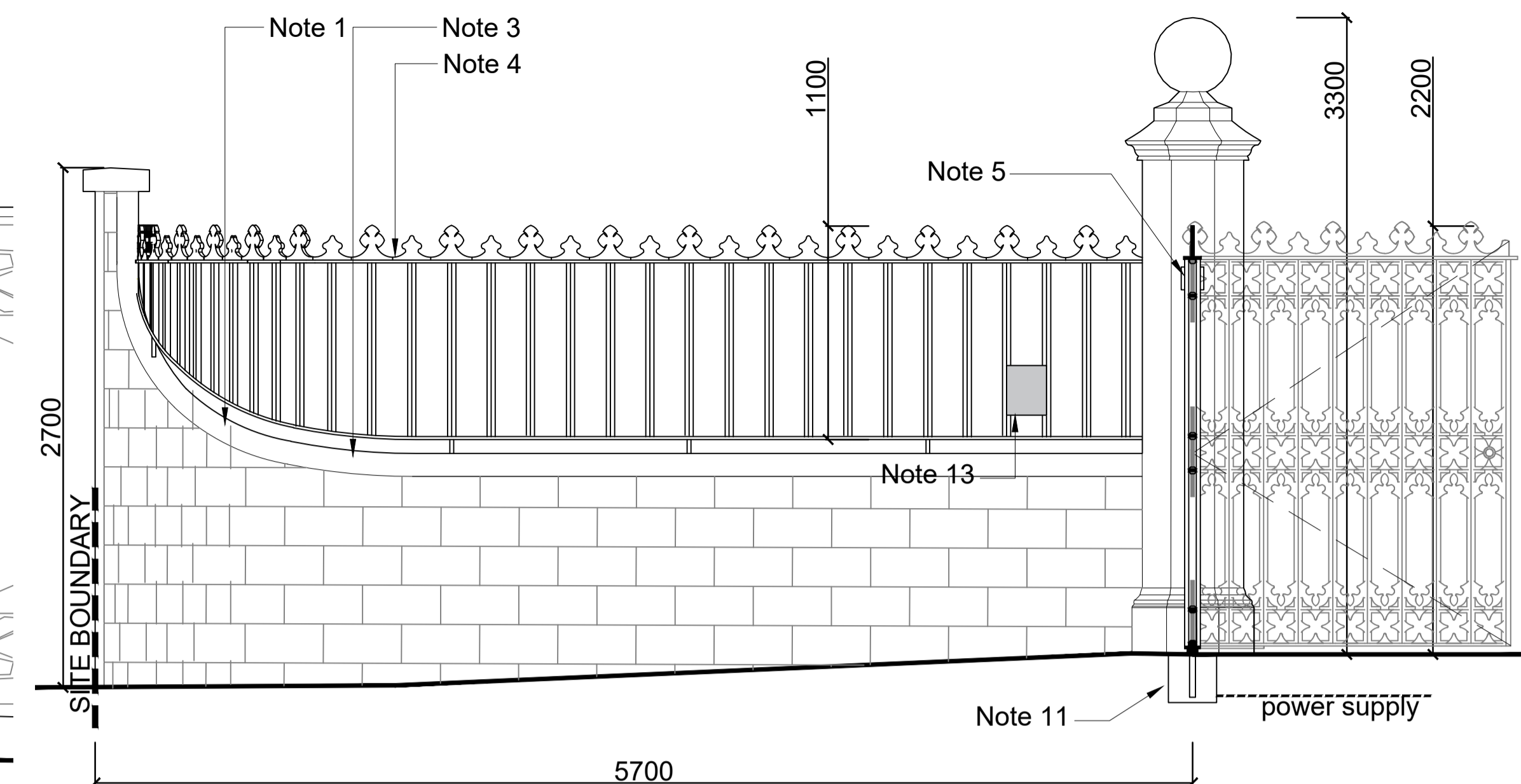

2 Section: Guthrie Road Gates: Proposed
Scale 1:25@A1

NOTES

General

- A. Gates and flanking walls are Grade II listed (1977) listing No. 1279642. They date from c 1850s. The proposal is to conserve the gates and undertake all necessary refurbishment to facilitate automated opening for use by pedestrians and private vehicles accessing the site (in only).
- B. The gates are cast iron, cast in a single piece from a mould.
- C. All the gates have dropped, indicating that the bottom hinge pintles have either worn significantly or rotted away.
- D. Flanking walls are coursed, quarry-faced grey limestone, with Bath stone copings. Joints to side walls are struck mortar and sound; Joints to copings are generally sound with some wear in places.
- E. Gate piers are ashlar Bath stone. Ball finials are believed to be a later addition. Open cavities to stonework around hinge inserts are present.
- F. Evidence of vehicle damage and repair to right hand gate leaf.
- G. Gates and stonework to be restored by suitably qualified metalwork and stone conservators. Full schedule of condition and technical details to be prepared based on site measurements for approval prior to fabrication.

Proposals Notes

- 1. All security mesh to be dismantled.
- 2. Conduit to outer pillar to be dismantled.
- 3. Coping stone joints to be raked out and re-pointed with a lime mortar, with brushed back finish.
- 4. Side railings to be repainted insitu with low sheen black exterior grade coating. Gold finials to be re-painted to match existing. Preparation to comprise sanding by hand and 2 part epoxy filling to cosmetic repair of corroded parts. Caulking to be inspected and raked out and replaced as required. Applies to both sides of entrance.
- 5. Gate strap hinges and internal bracket mounting to pier to be replaced with coatings to match existing. Cavity to be cut outs square, internal bracket to be chemically anchored into pier cavity (structural detail to be developed) and new matching stone toothed in to fill cavity around gate hinge bracket with lime grout. Brass bushes fitted between gate post and hinges. Applies to all gates.
- 6. All gates to be lifted out for repair and restoration under workshop conditions. Works to comprise sandblasting cleaning all paintwork and abrasions back to clean metal, in preparation for repair and redecoration to match existing with high durability exterior coatings. Cosmetic repairs to be undertaken using 2 part epoxy fillers, rubbed back to align profiles. See note 12 for mechanical repair to damaged gate.
- 7. Existing plaques to be replaced with cast metal hand-painted crests, cast in relief, based on the zoo heraldry, to match new entrance gates located elsewhere on site.
- 8. Proposed stone flush kerbs to demarcate pedestrian and vehicular / surfaces.
- 9. Stone gate pier plinths to be cleaned using a very light jet wash or equal approved method to remove scale and moss deposits.
- 10. Stone ball finials and capping stones to be cleaned using a very light jet wash or equal approved method to remove scale and moss deposits.
- 11. Ground recessed gate drive unit with internal electrical supply connected to a splined gate pintel, operated by fob / card reader for out of hours access. Unit to be programmed to open gates during daytime hours for public access.
- 12. Gate rail repair to comprise routed-out underside to fit a rebated plate with tapped screw fixings to hold parts together. Joint to be made good cosmetically using a 2 part filler.
- 13. Keypad access and fob reader.

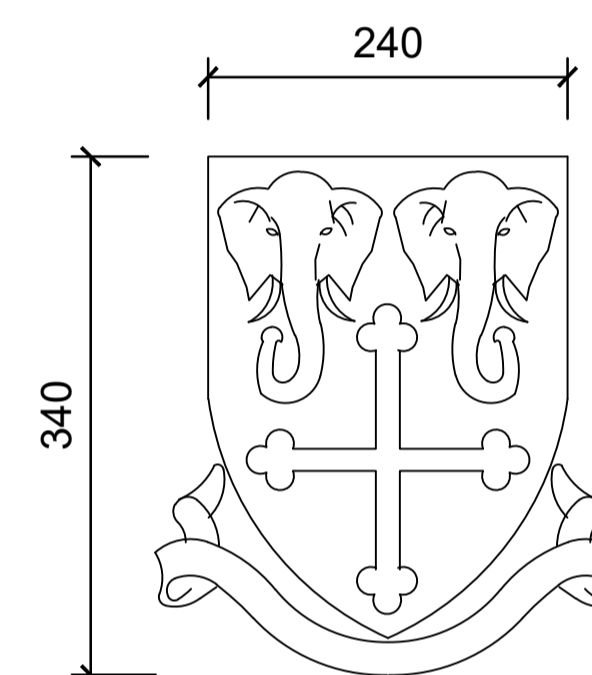

4 Crest detail
Scale 1:5@A1

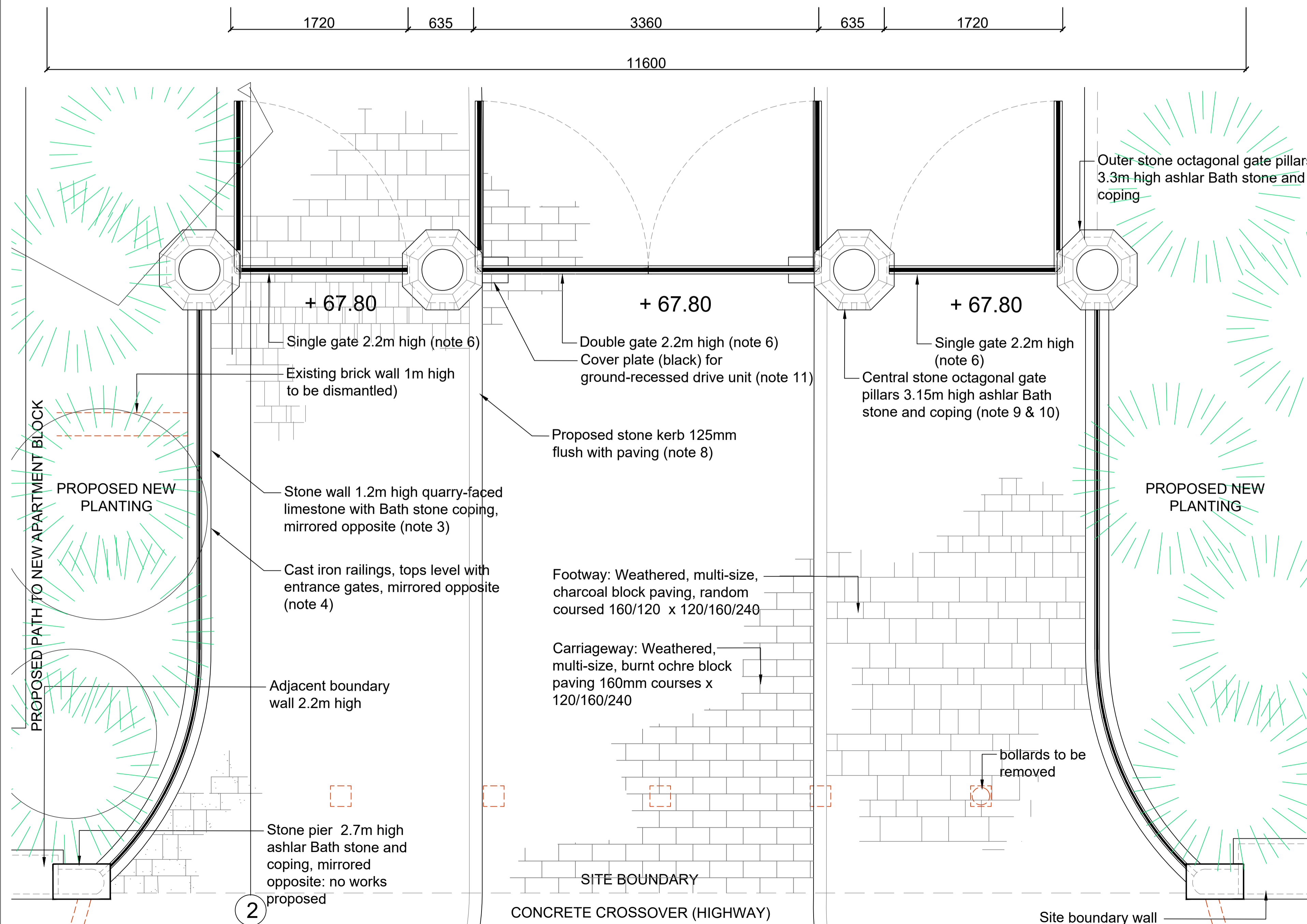

3 Plan: Guthrie Road Gates: Proposed
Scale 1:25@A1

THIS DRAWING TO BE READ IN CONJUNCTION WITH LISTED BUILDING CONSENT DETAILED PROPOSALS DRAWING 11585-LD-PLN-602

No.	Date	Description	Rev	CHK
A	20.05.22	Planning Application		EP EP

LUC LUC London
250 Waterloo Road, London, SE1 8RD
+44 (0)20 7383 5784
london@landuse.co.uk
www.landuse.co.uk

Project
Bristol Zoo Gardens (BZG)

Client
Bristol, Clifton & West of England Zoological Society Ltd (BCWEZS)

Scale @A1
1:25
Status
PLANNING

Drawing Title
Listed Building Consent Details
Guthrie Road Entrance Gates - Proposals

Job Nr	Drawing Nr	Issue
11585	11585-LD-DET-602	A

